



Sure to be Safe

Siegerland Bremsen

SIBRE

Siegerland Bremsen GmbH

Brake Technology and Monitoring
for Increasing Safety and Productivity

Matthias Grimm, Head of Components

SIBRE Siegerland Bremsen GmbH

- Private owned
- Founded in 1958
- Headquarter in Haiger (Germany)
- Assembly plant in Eschenburg (Germany)
- 17.500 m² production area in Germany
- 300 employees worldwide
- 13 international branches
- 50+ sales and service partner



AS A ONE STOP SUPPLIER, SIBRE DELIVERES COMPREHENSIVE SOLUTIONS FOR ALL DRIVES IN CRANES.

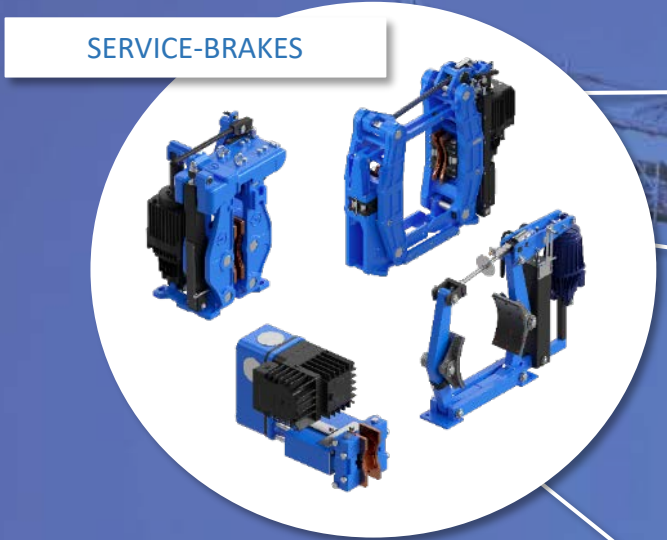

SERVICE-BRAKES

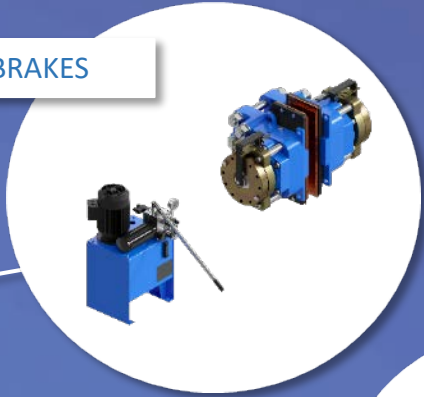

SAFETY-BRAKES

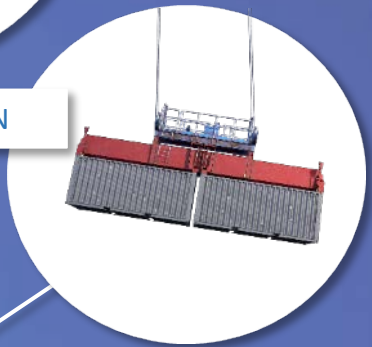

SNAG LOAD PROTECTION



STORM-BRAKES



WHEELS & SHEAVES



COUPLINGS



SIBRE invest to stay future-proof and reliable

- 3 new halls in total
- 18 new CNC machines + ABB handling robots
- > 17 Mio € investment since 2019
- Highest Energy Efficiency



SIBRE invest to stay future-proof and reliable



Headquarter Haiger



Assembly plant Eschenburg



SIBRE invest to stay future-proof and reliable



Existing test rig
Renewal of control,
measurement and
evaluation

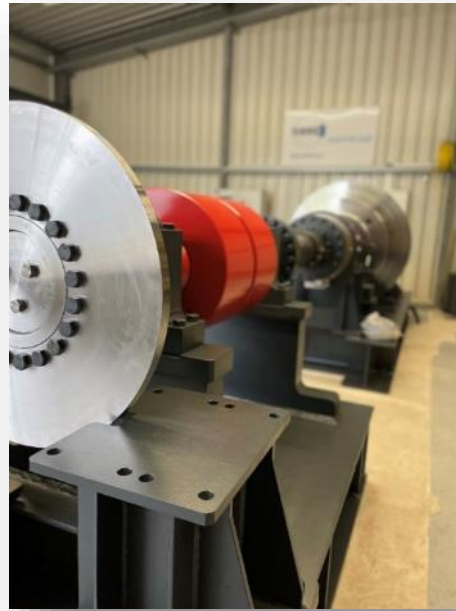

New dynamic test rig
Inertia up to 500 kgm²
Speed up to 2200 rpm



Dynamic storm brake test rig
Holding forces over 1000 kN

SIBRE new developments

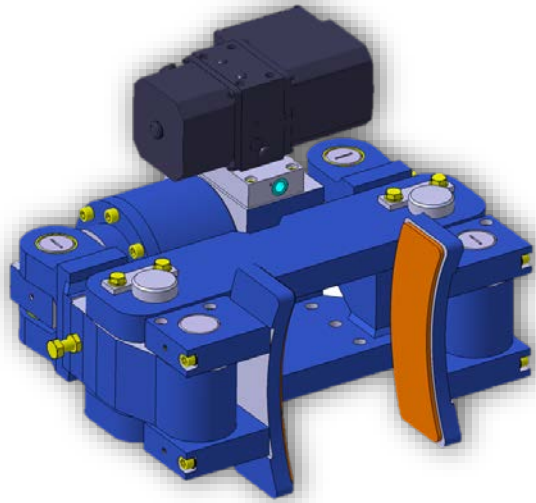

RHI face lift

Casted version

Braking forces up to 120 kN
available with at side HPU

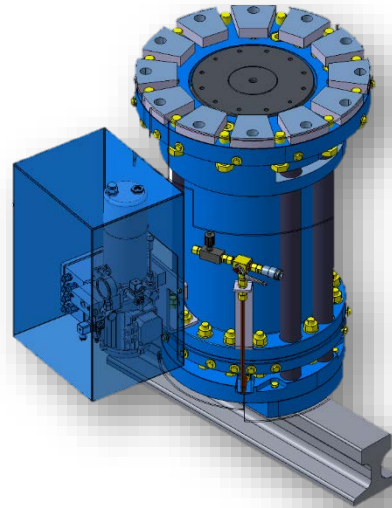

RPS with HPU at side

No piping along the bogie
Reduction of opening time

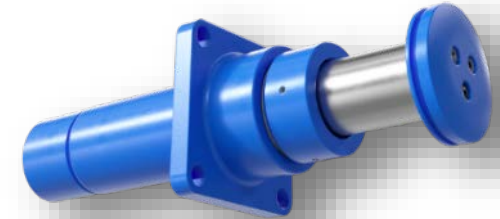

New buffer series SP

Forces up to 700 kN
Strokes up to 1200 mm

USB5 - Designed for all applications in a crane

Identical conditions in regards to installation, adjustment and maintenance

**main hoist
USB5-V**

**boom hoist
USB5-II or USB5-III**

**trolley travelling
USB5-I or USB5-II**

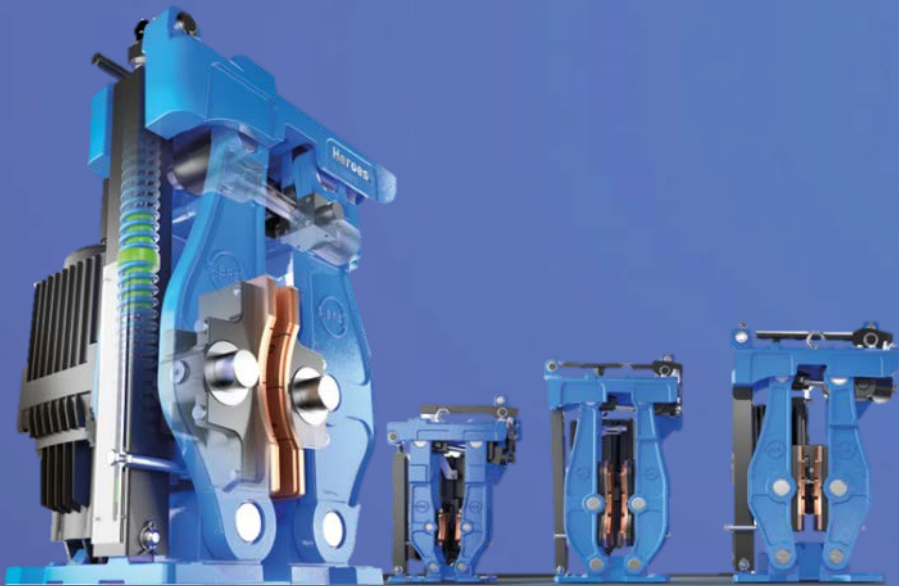

**gantry travelling
USB5-05**



Improved features – USB5

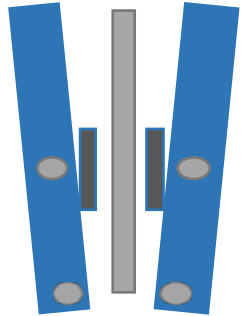

Parallel opening of brake shoes

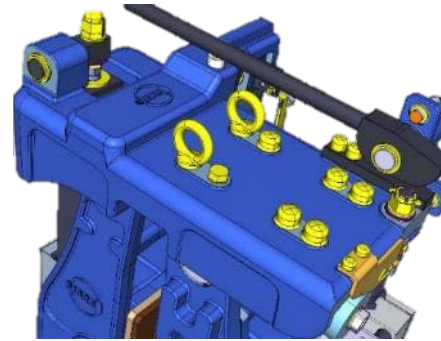

Enhanced corrosion protection



Optimized spring unit



Upgraded manual release system

SSM - SIBRE Status Monitoring

Brake monitoring and status visualization of:

Brake open

Brake closed

Manual release

Pad wear

Pad temperature

Reserve stroke

Contact force OR Brake torque

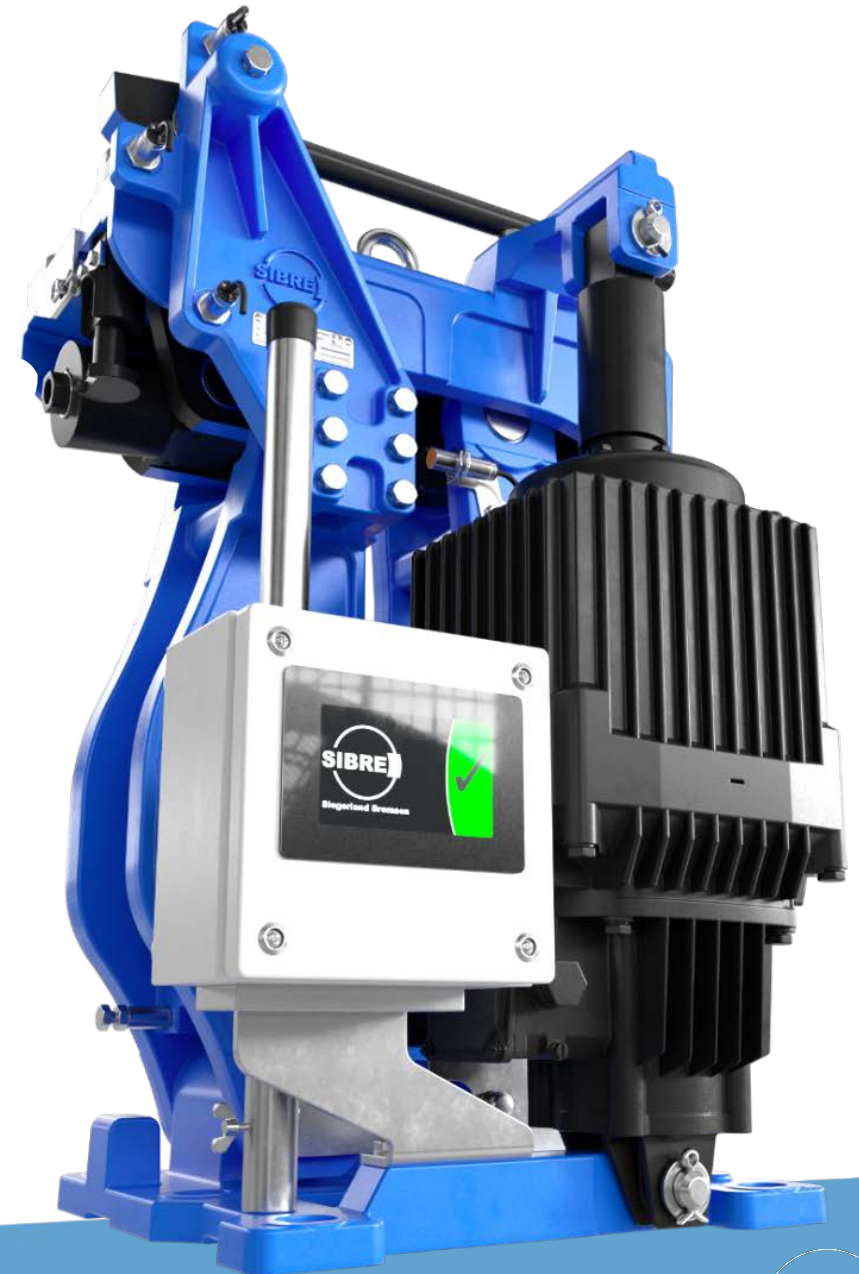

Service & Support

- increased stock capacity (≈5.000.000€)
- fast spare parts availability
- online services & support
- training on the brake simulator
- WEBINAR´s upon request
- maintenance tutorial-videos
- further support upon request
- service staff & supervisor availability



References

LIEBHERR

Lifting Global Trade.
**APM
TERMINALS**

HHLA

 **CARGOTEC**

M
mitsui E&S

 **PACECO CORP.**

 **DP WORLD**

**COSCO
SHIPPING**

ZPMC

künz

KOCKS



 **PSA SINGAPORE**

KONECRANES
Lifting Businesses™

 **HYUNDAI**
HEAVY INDUSTRIES CO.,LTD.

HPH

BALTKRAN
www.baltkran.ru

YILPORT

 **EUROGATE**

Maximize your efficiency by

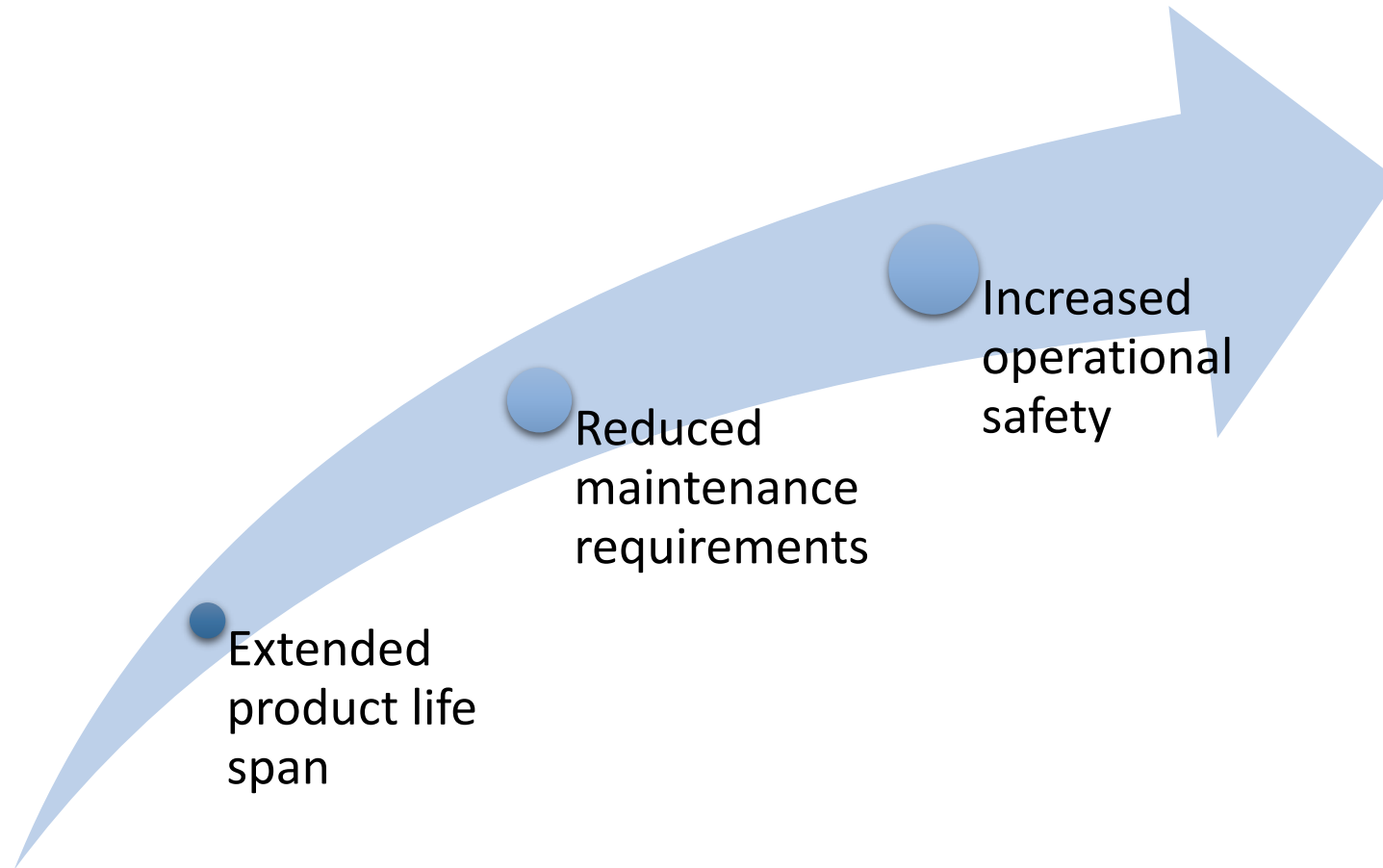



Sure to be Safe

Siegerland Bremsen

intermodal
AFRICA 2023 

The main title of the event, "intermodal AFRICA 2023". "intermodal" is in a yellow, lowercase, sans-serif font. "AFRICA" is in a large, bold, orange-to-red gradient, uppercase, sans-serif font. "2023" is in a smaller, orange, uppercase, sans-serif font. To the right of "AFRICA" is an orange silhouette map of the African continent.

Thank you!

mg@sibre.de | www.sibre.de

