

# Brake Technology and Monitoring for Increasing Safety and Productivity

Maik Zielberg – technical sales

**SIBRE**

*Sure to be Safe*

Siegerland Bremsen



# SIBRE Siegerland Bremsen GmbH

- Private owned
- Founded 1958
- Headquarter in Haiger in Germany
- Assembly plant in Eschenburg in Germany
- 17.500 m<sup>2</sup> production area in Germany
- 300 employees worldwide
- 13 International branches
- 50+ Sales and service partner





# SIBRE invest to stay future-proof and reliable



HQ Haiger approx. 12 Mio in 2018-2021



Facility Eibelshausen approx. 5 Mio in 2022-2023



# SIBRE invest to stay future-proof and reliable

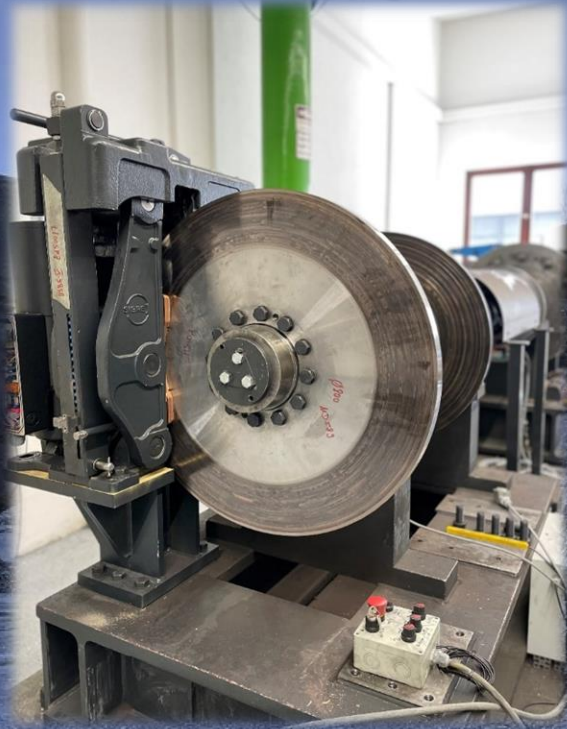

**Existing test rig**

Renewal of control,  
measurement and  
evaluation



**New dynamic test rig**

Inertia up to  $500 \text{ kgm}^2$   
Speed up to 2200 rpm



**Dynamic storm brake test rig**

Holding forces over 1000 kN



AS A ONE STOP SUPPLIER,  
SIBRE DELIVERS COMPREHENSIVE  
SOLUTIONS FOR ALL DRIVES IN CRANES.



SAFETY-BRAKES

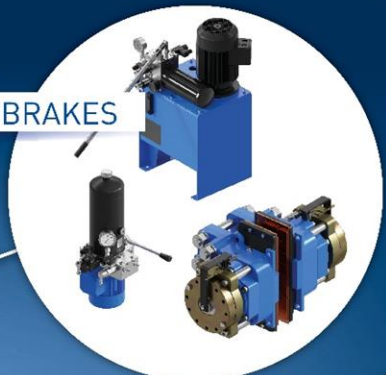

SERVICE-BRAKES



SNAG LOAD PROTECTION



STORM-BRAKES



WHEELS & SHEAVES



COUPLINGS





# SIBRE new developments

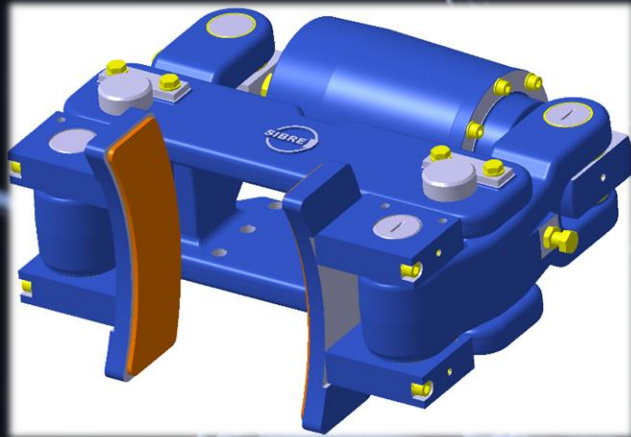

## RHI face lift

Casted version  
Braking forces up to 120 kN  
available with at side HPU

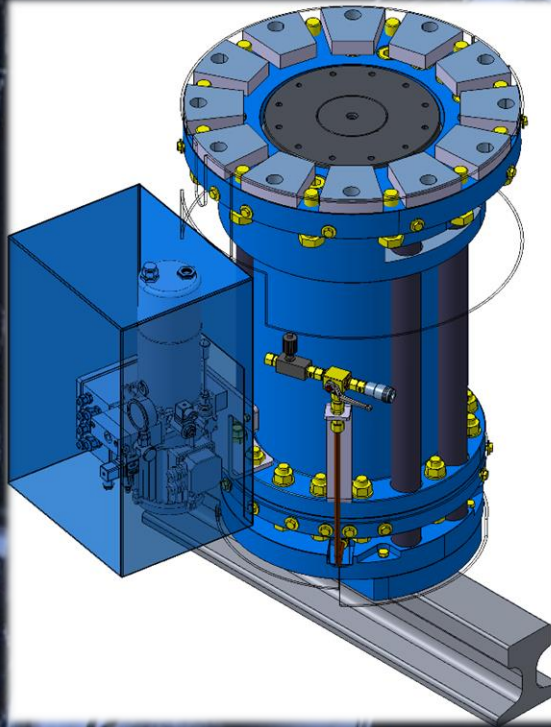

## RPS with HPU at side

No piping along the bogie  
Reduction of opening time



## New buffer series SP

Forces up to 700 kN  
Strokes up to 1200 mm

# USB5 - Designed for all applications in a crane

Identical conditions in regards to installation, adjustment and maintenance

main hoist  
USB5-V

boom hoist  
USB5-II or USB5-III

trolley travelling  
USB5-I or USB5-II

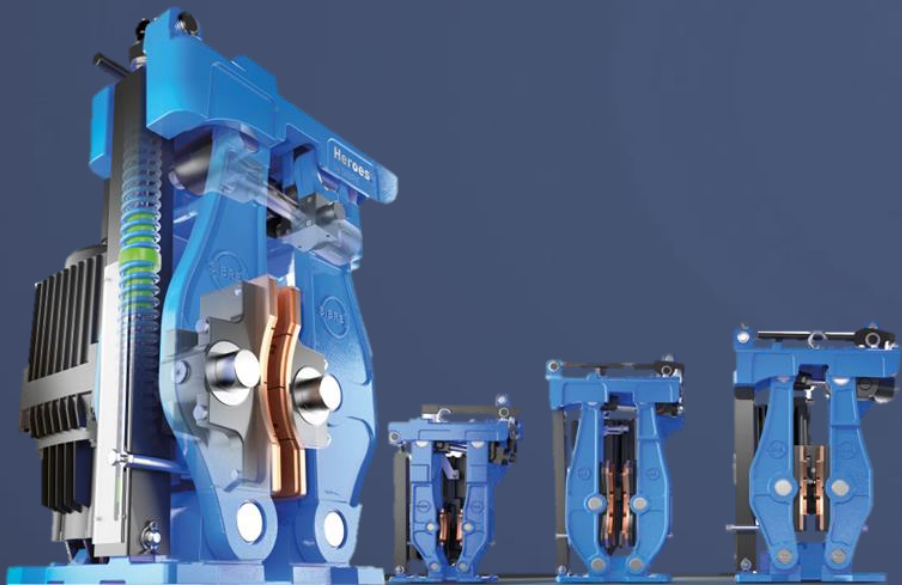

gantry travelling  
USB5-05





# SSM - SIBRE Status Monitoring

**Brake monitoring and status visualization of:**

**Brake open**

**Brake closed**

**Manual release**

**Pad wear**

**Pad temperature**

**Reserve stroke**

**Contact force OR Brake torque**





The background image shows a trade show booth for SIBRE. A large circular logo with the word 'SIBRE' is suspended from the ceiling. Below it, a banner reads 'Heroes by SIBRE'. To the right, a vertical banner says 'SAFETY AND RELIABILITY FOR PORT OPERATION'. On the far right, a large wall features the words 'SAFETY', 'SNAG', 'LOAD', 'STORM', 'CRANE', 'STATUS', and 'HYDRAULIC' stacked vertically. In the foreground, several people in business attire are gathered around a display table.

**Maximize your operation hours efficacy caused by**

- Increased operational safety
- Reduced maintenance requirements
- Extended product life span

**Questions? Visit us at booth 5!**